

Mistifyfuse is the sheerest of fusibles, yet has the ability to migrate into fibers for the strongest hold. Mistifyfuse is a joy to work with and Mistyfuse fabrics stay soft to the touch. Mistyfuse *never* puts a gummy residue on sewing needles because there are no added adhesives in Mistyfuse. The bond can be reactivated with steam heat, yet holds for wet painting, machine washing and dry cleaning. Mistyfuse is an environmentally responsible product manufactured in the U.S. in a regulated, green industrial park.

Mistifyfuse: The Basics

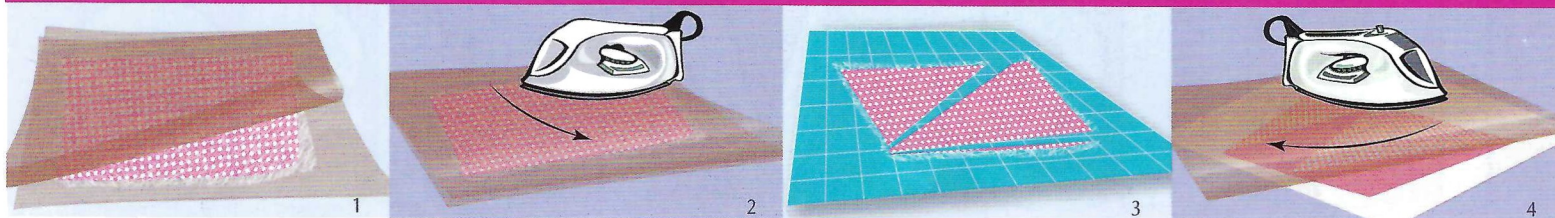

- 1| Work between nonstick surfaces.*** With the fabric back-side up, layer Mistifyfuse on top, then a nonstick cover.
- 2|** Glide a hot iron to melt Mistifyfuse into the fabric, making it more transparent/less white. Peel back the covering slowly, checking for any spots that might need more ironing.
- 3|** Cut out the shape, position and pin in place. **TIP**—try a swift poke with the tip of a hot iron for a removable *virtual* pin.
- 4|** Use a nonstick cover over placed shapes to keep your hot iron gliding easily as you iron them down permanently.

Temperature Guide: Let your fabric be your guide for time and temperature. If your fabric requires a lower temperature, try layering the heat to build a deep bond. 2 or 3 swift passes gliding a hot iron, with a light hand, removing and replacing the protective nonstick cover with each pass. Removing the cover helps dissipate the heat build-up while allowing the fuse time to reach into the fibers for a strong bond. It also helps prevent the formation of air bubbles between fabric and fuse when fusing sheers or tightly woven synthetics.

***Always use a nonstick sheet above and below to protect your iron and work surface from direct contact with fusible.** The ultra-sheer Goddess Sheet®, also from Attached Inc., is our preference because of the superior heat distribution properties that make ironing faster, but some other nonstick pressing sheets and silicon-coated baking parchment paper are also suitable.

Ironing Tip: No pressing with Mistifyfuse! And no counting necessary. Glide the iron... moving left to right or outward from the center with light pressure. For best results when fusing, iron on a firm surface.

Teflon® is a registered trademark of E. I. du Pont de Nemours and Co.

★ Mistifyfuse is pure spun fusible with no added adhesives on the surface. So both sides of Mistifyfuse are identical—both sides are “right.”

Design Transfer & Mistifyfuse® plus Tips&Tricks

Transferring a pattern or design is **easy** with paperless Mistifyfuse. **NO reversing** and no need to cut through paper—so fewer mistakes. Here are 4 ways to **Work Forward™** using Mistifyfuse...

- 1|** Use a pencil to trace the design, (without reversing) onto silicon-coated parchment paper. Place Mistyfuse fabric—fuse side down—on top of the pencil tracing (or layer Mistifyfuse then fabric over the pencil line). Cover and iron the fabric to the parchment. As you peel the parchment off the fabric, the pencil line sticks to the Mistifyfuse, putting a perfectly reversed guideline directly on the back of the fabric, giving you the option of removing the paper before cutting, or leaving it on if you like. Use a #2 pencil for most fabrics, a white pencil or other light colors for darks. Polychromos or similar pencils work best.



Pencil tracing on parchment paper auto-reverses onto the back of fabric

NOTE: For **pre-reversed** patterns, trace the shapes then flip the tracing over, and place Mistyfuse fabric **on the back** of the parchment. Iron the fabric to the paper and now leave the paper on to cut out the shapes.

- 2|** Now you can use a desktop-printer instead of tracing to transfer designs! Print on our new **Bunny Paper®** then iron Mistyfuse fabric on top to transfer the print to the back of fabric—perfectly reversed!



Print on Bunny Paper for easy design transfer

- 3|** Trace guidelines directly on the front of prefused fabric with chalky, non-waxy, reusable Transdoodle®.
- 4|** Iron right-reading freezer paper templates to the top of prefused fabric. Cut along template contour.

★ Tips & Tricks ★

- 1|** Our **#1 tip** is to **prefuse** your fabrics for a project then put the bolt or package of Mistifyfuse away. Prefusing makes everything easier, neater and more efficient. Since Mistifyfuse is solvent-free, prefused fabrics can be stored for weeks or even months or years with no harm or loss of function. (Cool for 15 minutes before folding.) Prefusing fabric is a timesaver with each of our “work

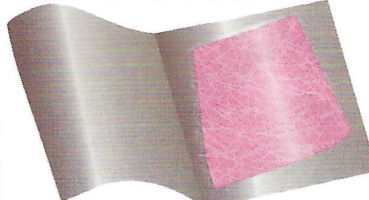

Prefusing on a Goddess Sheet

forward” pattern transfer methods and ideal for free-form cutting.

- 2|** The Goddess Sheet® puts a glossy sheen on fused surfaces that is helpful for identifying easily the Mistyfuse side of prefused fabric. Parchment paper gives Mistifyfuse a matte look, which can make White Mistifyfuse visually disappear.
- 3|** Use **Mistifyfuse for basting!** Place bits between quilt top and batting then iron for the easiest and **best basting ever!** No more pricked fingers, no broken needles, no snow plowing, no mess, never gummy, so soft you’ll even forget it’s in there.
- 4|** Color Mistifyfuse for surface effects or a color effect under a sheer. Gently massage fabric paint or dry pigment powders into Mistifyfuse. Mistifyfuse will bind with the paint or pigments when ironed. Black Mistifyfuse is the best choice for most colors and metallics.
- 5|** Reuse parchment paper over and over. Rub off and discard any clinging bits of Mistifyfuse.

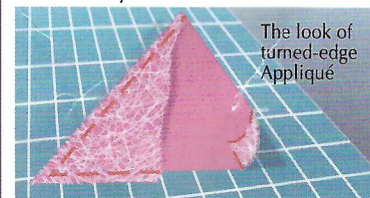

The look of turned-edge Appliqué

- 6|** The look of turned-edge appliqué with the ease of raw edge: sew Mistifyfuse to the front of your fabric shape. Cut a slit in the Mistifyfuse then turn (pillowcase) the shape inside out. Mistifyfuse will hold the turned-edge as you fuse down the shape. For a puffed look, lightly stuff before fusing.



Making paper/fabric

- 7|** Make paper/fabric: place bits of fabric, roving, ribbon, yarn, paper, etc. between multiple layers of Mistifyfuse. Place between nonstick surfaces then iron to fuse it all together, into a paper/fabric, then cut it up to fuse anywhere.
- 8|** Mistifyfuse helps keep the cut edges of silks, sheers and other fabrics from fraying.
- 9|** The sheerness of Mistifyfuse allows doubling up without adding bulk.
- 10|** Iron prefused fabric to Bunny Paper® to print on fabric in your inkjet or laser printer.
- 11|** Use up any Mistifyfuse scraps! Overlapped pieces of fuse, fuse without ridges. They’re also handy for a custom patch or a quick hem or for basting.
- 12|** Use Mistifyfuse with paper, wool, leather, felt and more.

- Use caution with hot fusible—allow it to cool before handling.
- Some fabrics have finishes which can interfere with fusible adhesion. Washing fabrics prior to fusing is recommended.
- Always protect your iron and work surface from fusible and remove any excess fusible clinging to the nonstick sheets. But when accidents happen...ironing over a laundry dryer sheet or a folded wet towel, scrubbing with a scrubbie, using oven cleaner, are some of the methods used to remove fusible from irons.